

Center for Health Research and Rural Advocacy CHRRRA



Angela Nudy
Pennsylvania State University
Lighting/Electrical Option
Faculty Advisor: Dr. Mistrick

Images Compliments of Ewing Cole

DEDICATED TO HEALTH CARE,
EDUCATION, RESEARCH, AND SERVICE

GEISINGER

Center for Health Research and Rural Advocacy

Brief Overview

- Location: Geisinger Health System Campus in Danville, Pa
- Size: 63,000 sq ft
- Total Cost: \$18.5M
- Scheduled Completion: February 2007
- Sustainable Design: Slated to become LEED Silver
- Purpose: New facility for research and education on innovative techniques to solve common rural area health care issues.



Building Overview: Floor Plans

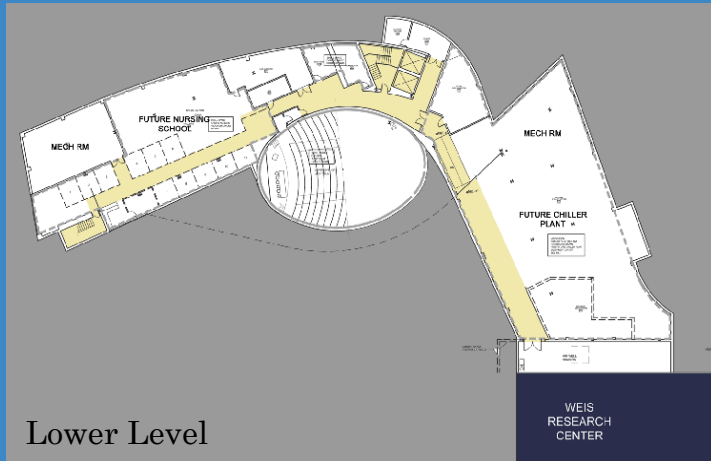

Lower Level

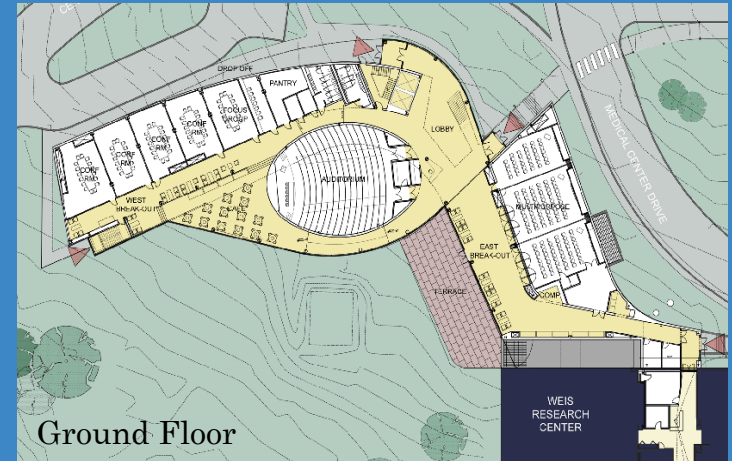

Ground Floor



First Floor

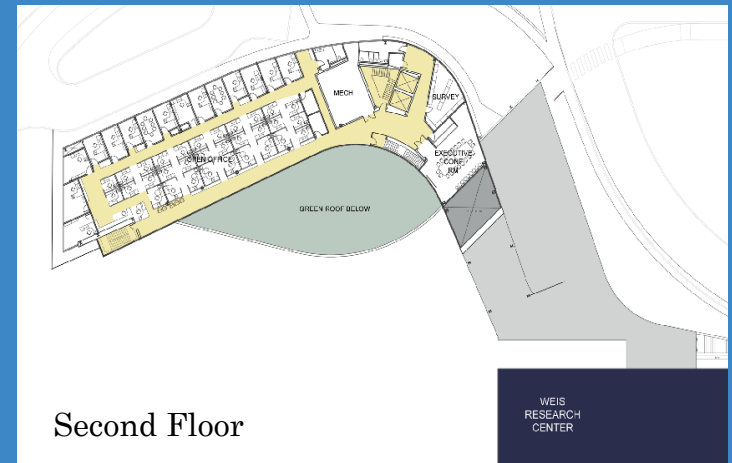

Second Floor

Interior Redesign Spaces

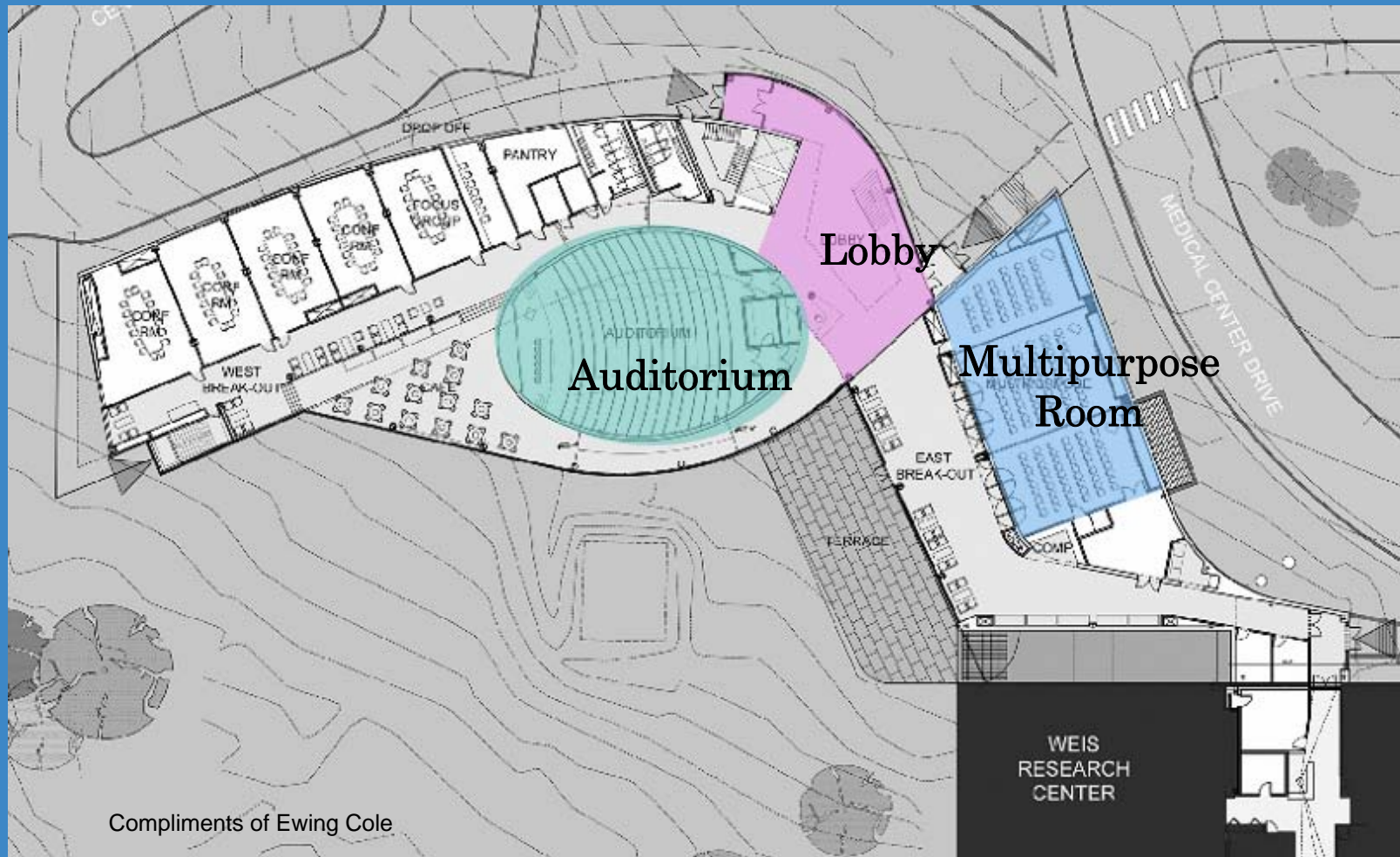

Compliments of Ewing Cole

Interior Redesign Spaces

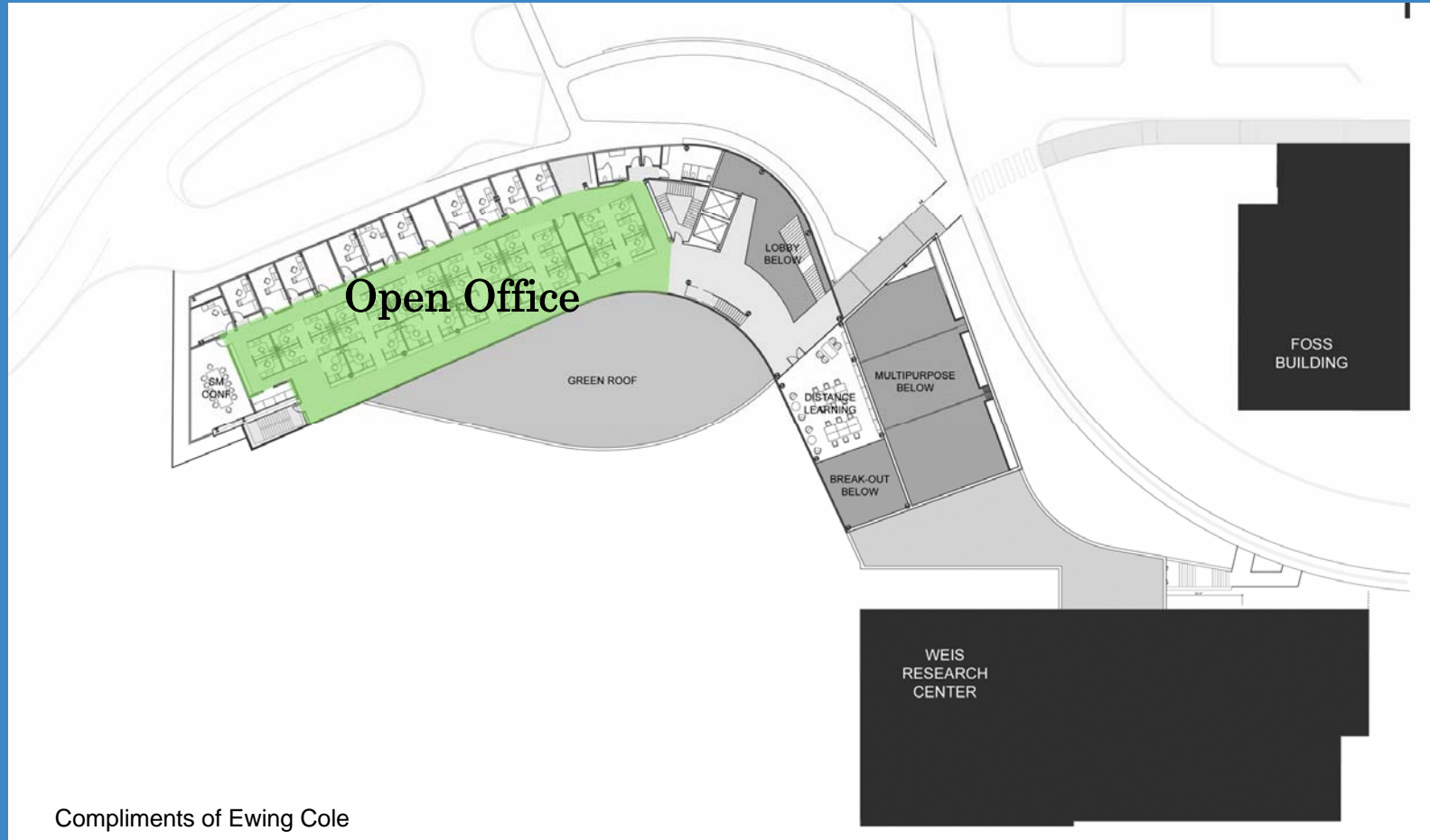

Building Lighting Concept

CHHRA is the mainframe of knowledge for Geisinger, the data center for new ideas and technologies, and the information highway of medical improvements.



DEDICATED TO HEALTH CARE,
EDUCATION, RESEARCH, AND SERVICE

GEISINGER
Center for Health Research and Rural Advocacy

Main Lobby

Design Goals:

- Create interest in space
- transition between exterior and interior light levels
- Unique view from exterior
- Balance natural and electric light
- Comfortable atmosphere with non-uniformity



Important Areas/Tasks:

- Reading/writing in break out space
- Reception desk
- Stairs
- Elevator entrances

Main Lobby

Room Surface Materials

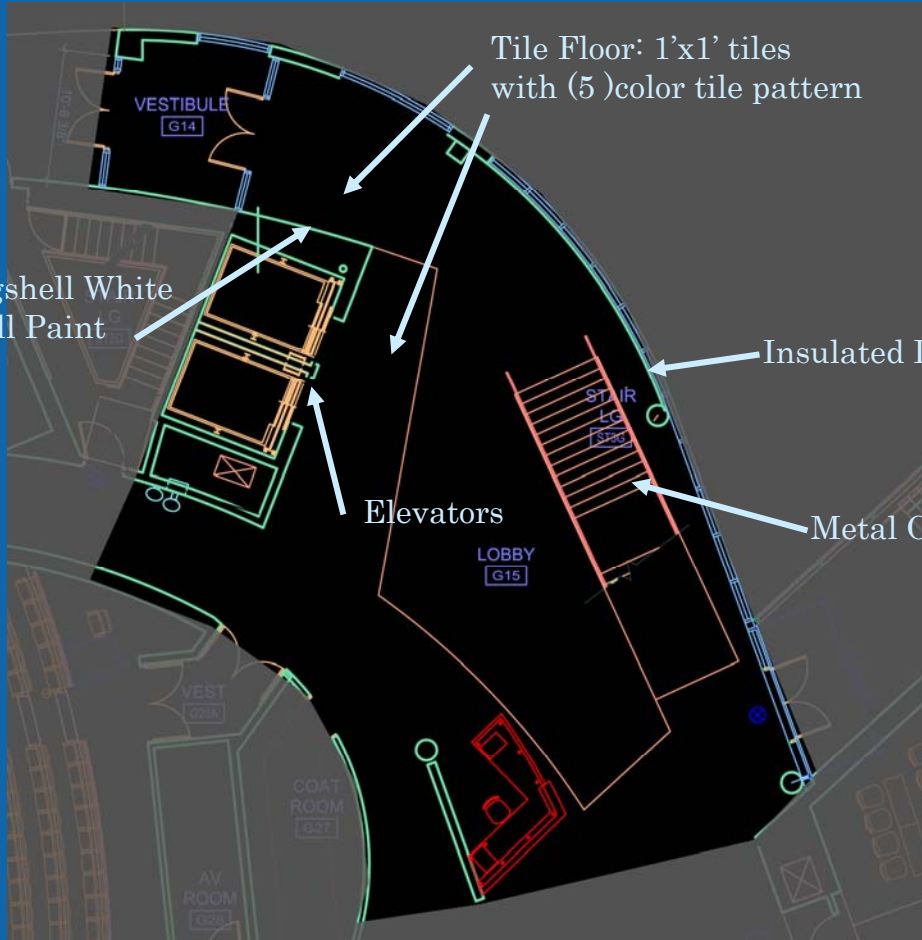

Ground Floor Reflected Ceiling Plan

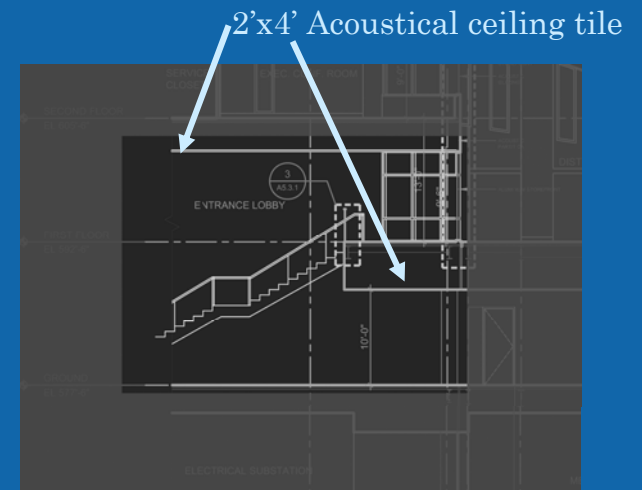

Main Lobby

Schematic Lighting Design

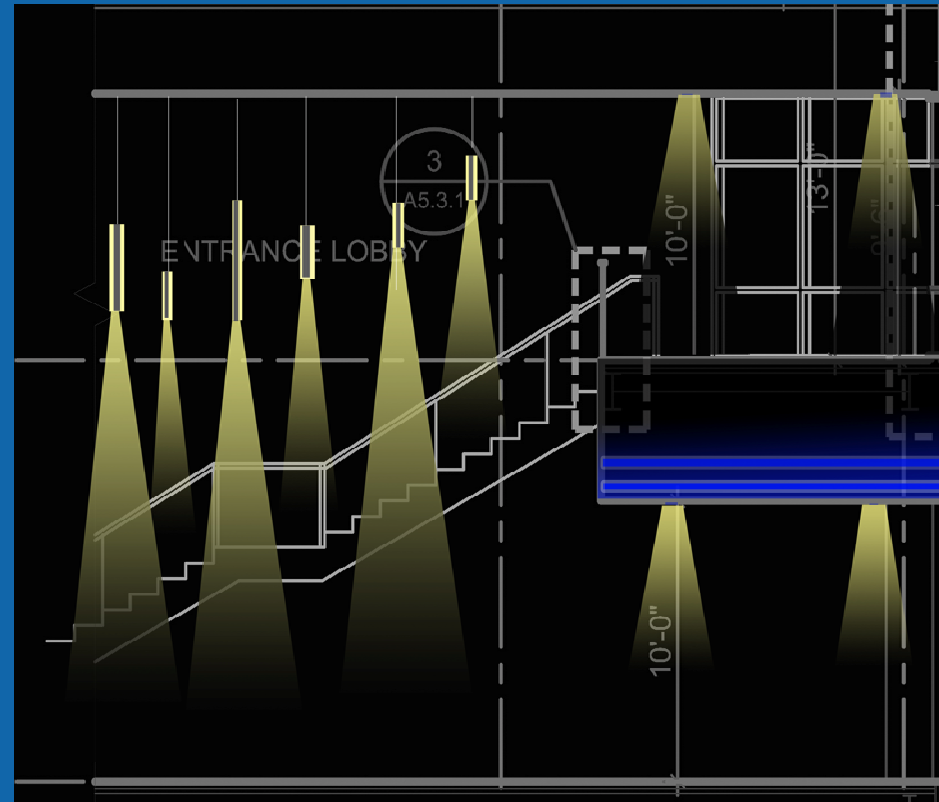
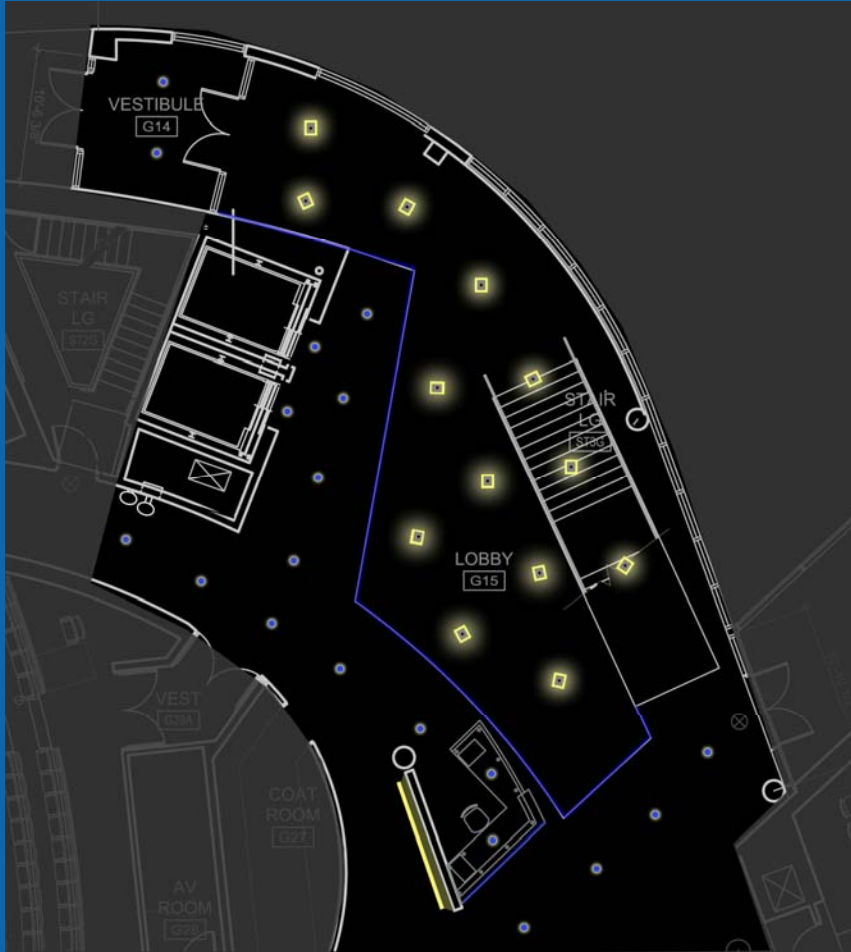

Main Lobby

Schematic Lighting Design

- Compact Fluorescent downlight with decorative glowing blue double ring
- Linear LED blue wash under reception desk
- Custom Linear Pendant (LED) with (4) lamps at different lengths and mounting heights in a linear aluminum housing with a recessed downlight component on the bottom

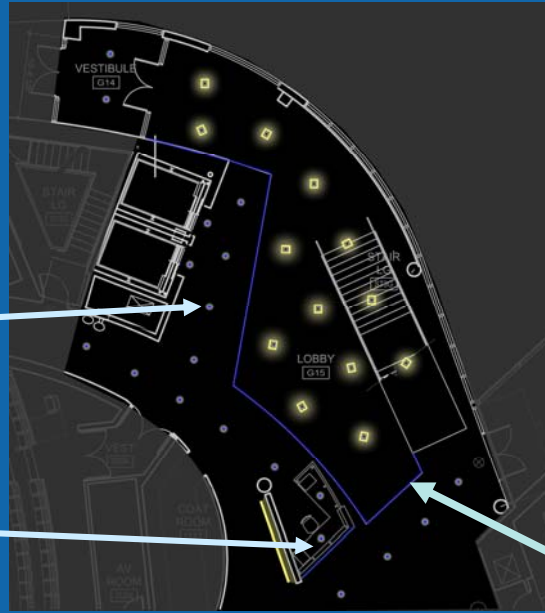

Cove Fixture Slot Detail

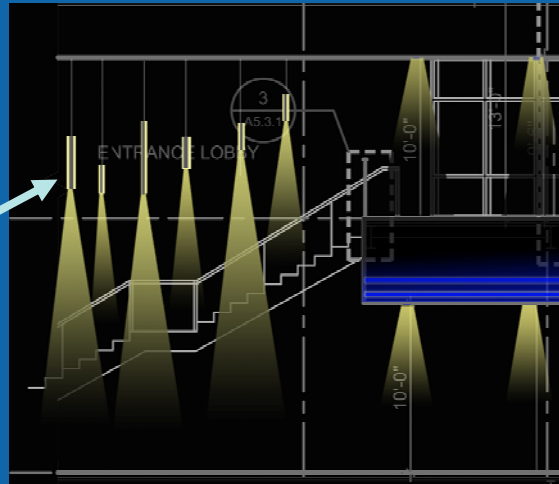
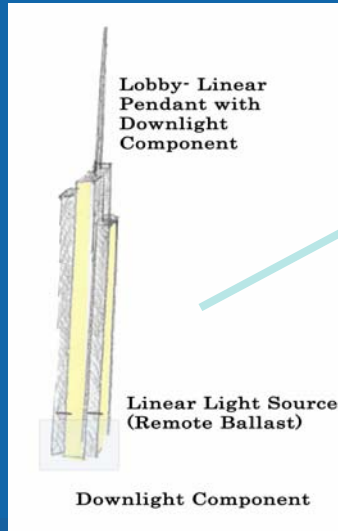
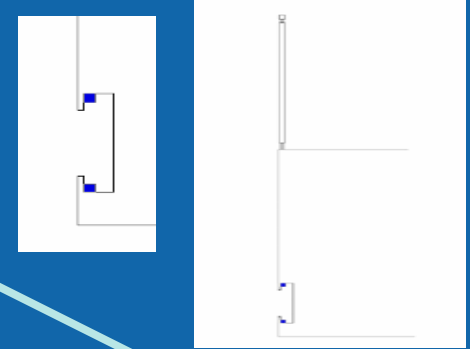

- Linear LED fixture recessed in small wall slot along the bottom of the second floor around the double height lobby.

Main Lobby

Schematic Lighting Design



Exterior View of Lobby
At Night

Auditorium

Design Goals:

- Create a flexible lighting system that can be adapted for multiple uses.
- Layer light levels to draw attention to the speaker and or presentation.
- Minimize direct glare while also providing adequate vertical illuminance for facial modeling.
- Create an atmosphere that will enhance group discussion and the connection between speaker and audience.

Important Areas/Tasks:

- Lectures
- Presentations
- Group Discussions
- Projector Screen
- Writing/Reading at audience seating

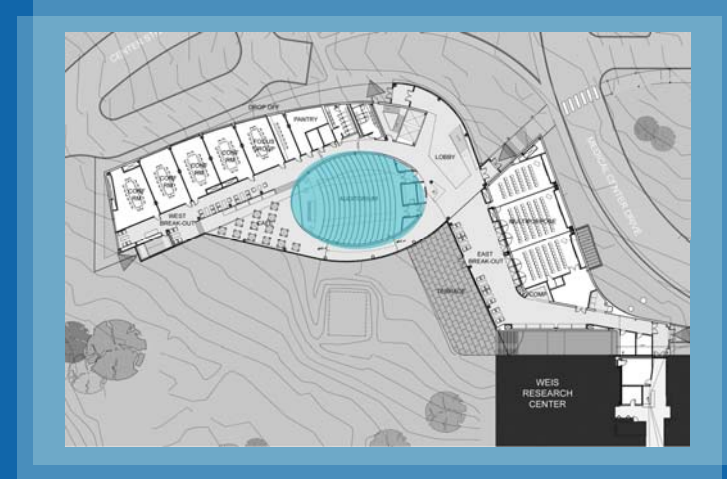

Auditorium

Room Surface Materials

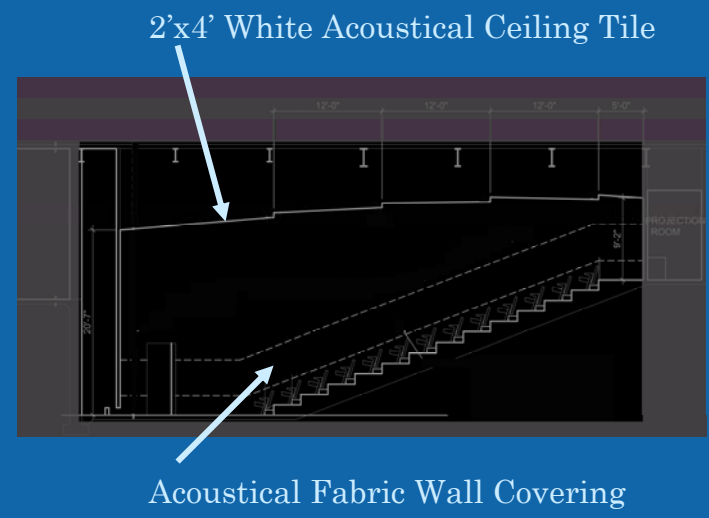
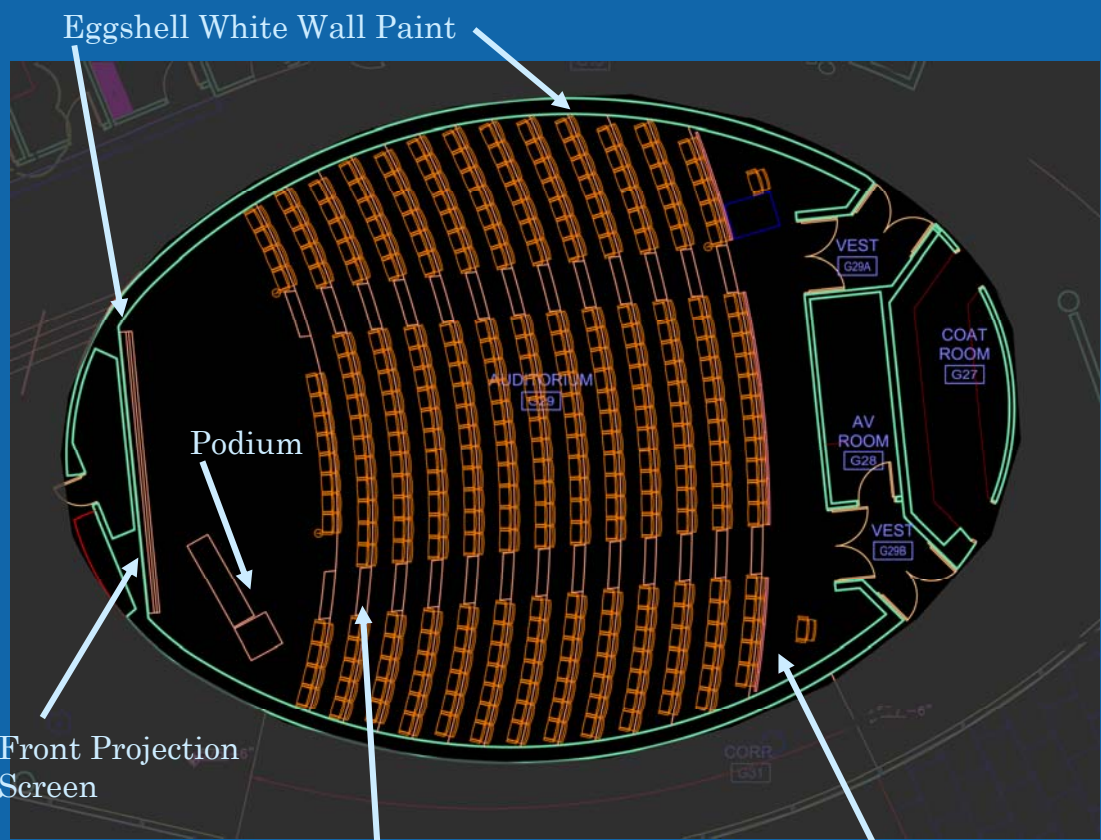
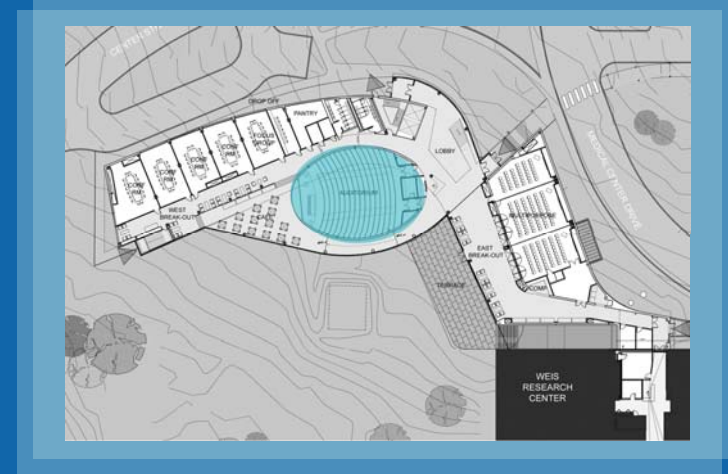

Auditorium

Schematic Lighting Design

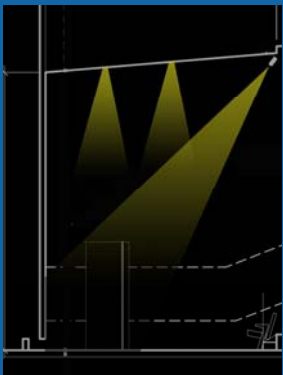
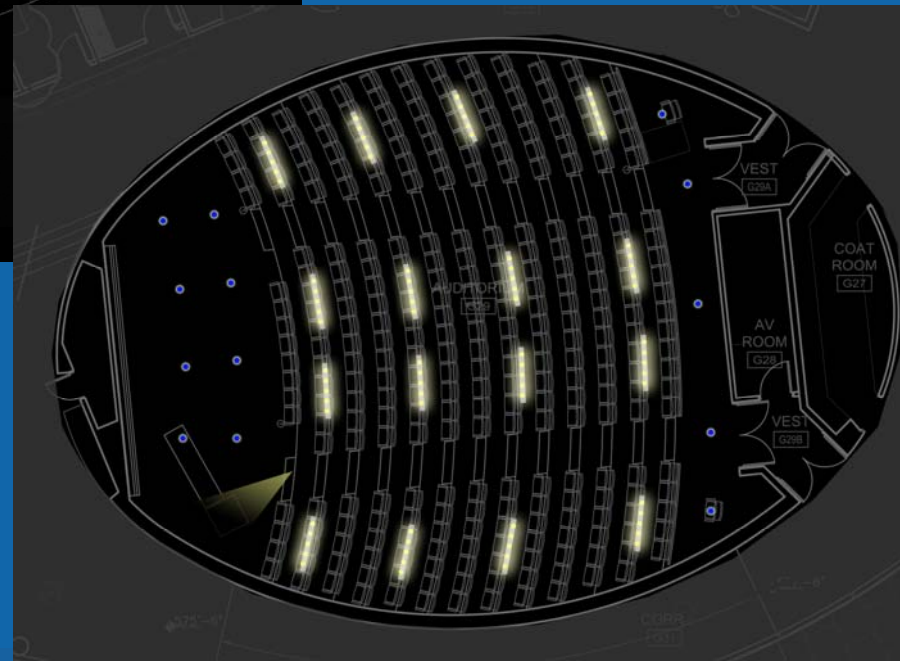
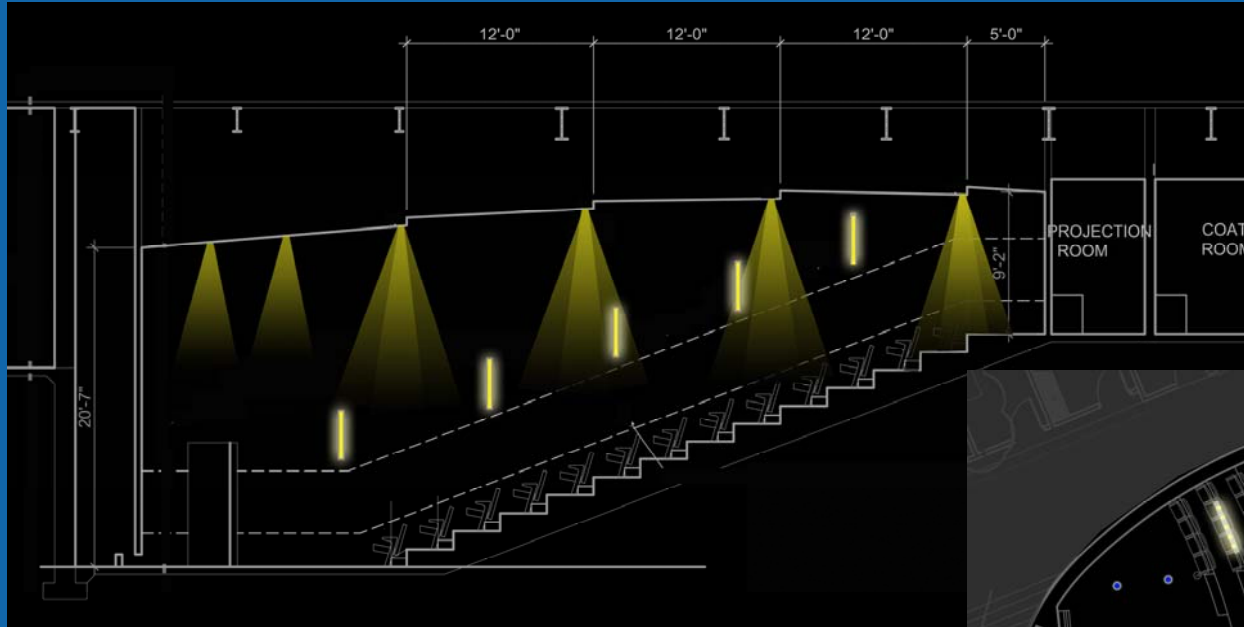

Keylight detail for Podium

Auditorium

Schematic Lighting Design

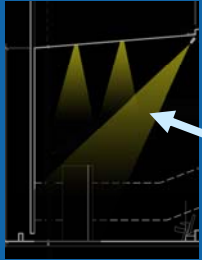
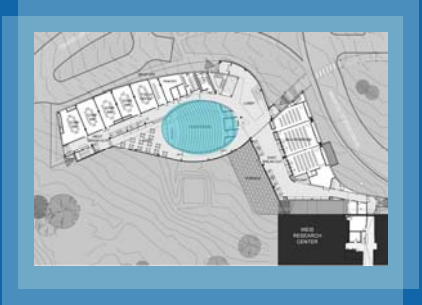

Recessed spotlight

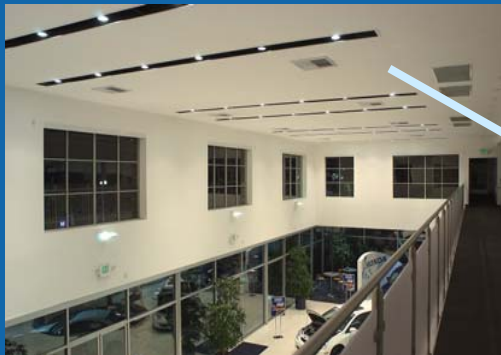
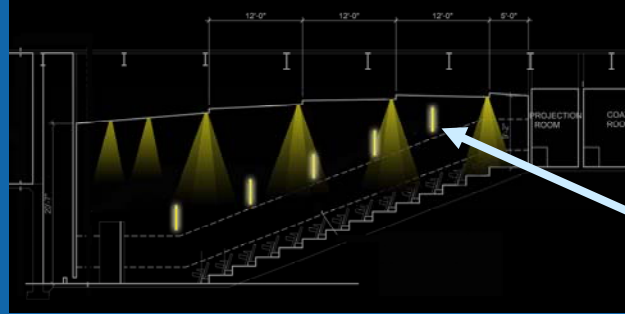

Adjustable Recessed multi-lamp fixture

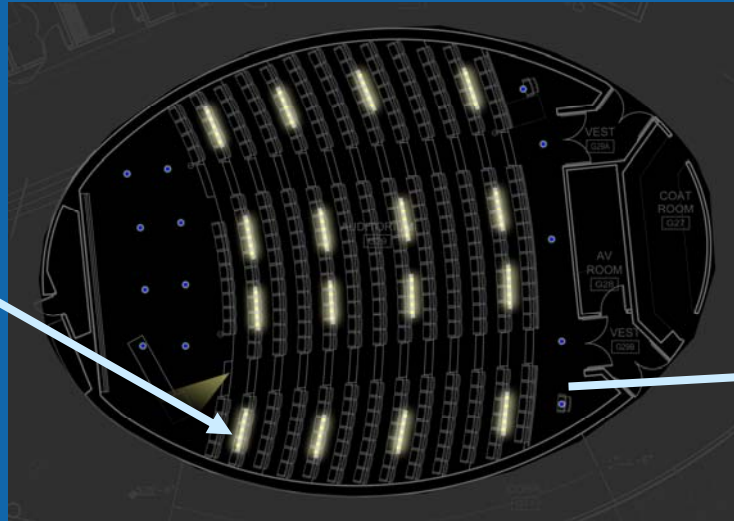

Multipurpose Room

Design Goals:

- Create a flexible lighting system that is adequate for multiple settings.
- Create both the option for both a calm/comfortable atmosphere and a professional/visually clear atmosphere.
- Avoid direct glare and veiling reflections for possible visual equipment, computers, etc.
- Adequate vertical illuminance for facial modeling.
- Create a lighting system that works as one unit or as three when the movable partitions are closed.

Important Areas/Tasks:

- Presentations
- Informal Luncheons
- Private Banquets
- Projector Screens in each section
- Reading/Writing at desks
- Eating/Food Presentation in banquet setting



Multipurpose Room

Room Surface Materials

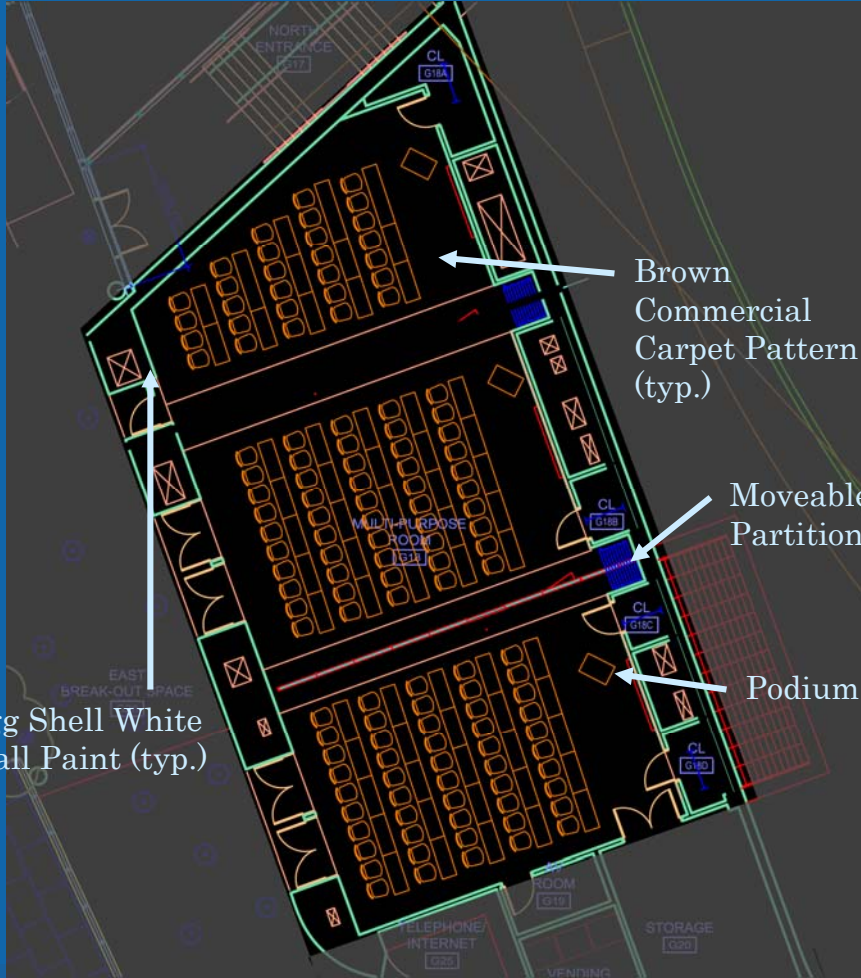

Brown Commercial Carpet Pattern (typ.)

Moveable Partitions (typ.)

Podium (typ.)

Egg Shell White Wall Paint (typ.)

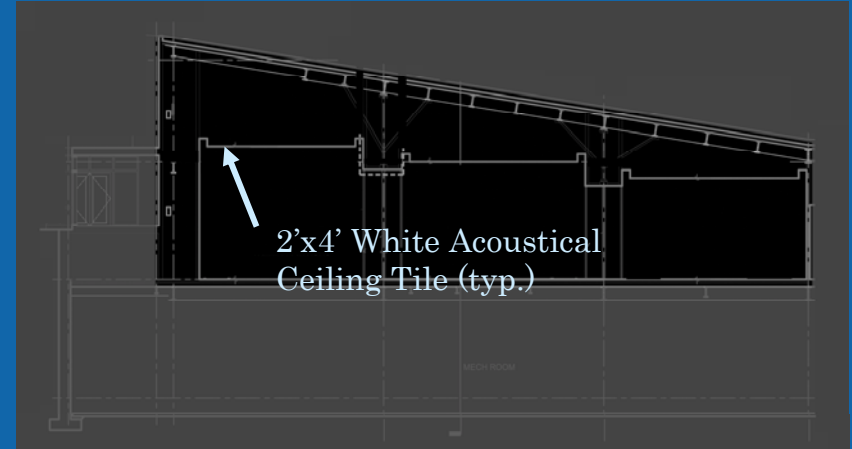
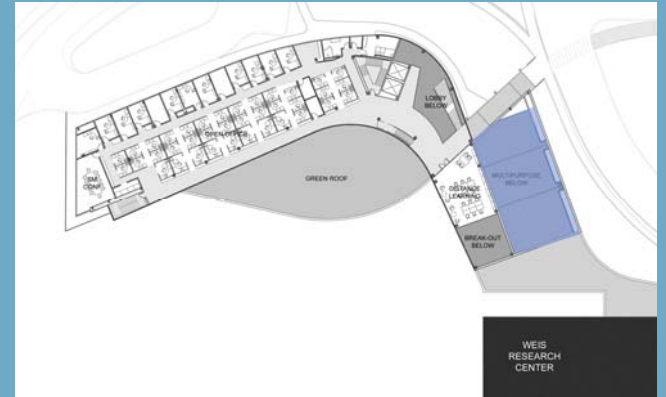

2'x4' White Acoustical Ceiling Tile (typ.)

Multipurpose Room

Schematic Lighting Design: Presentation Mode

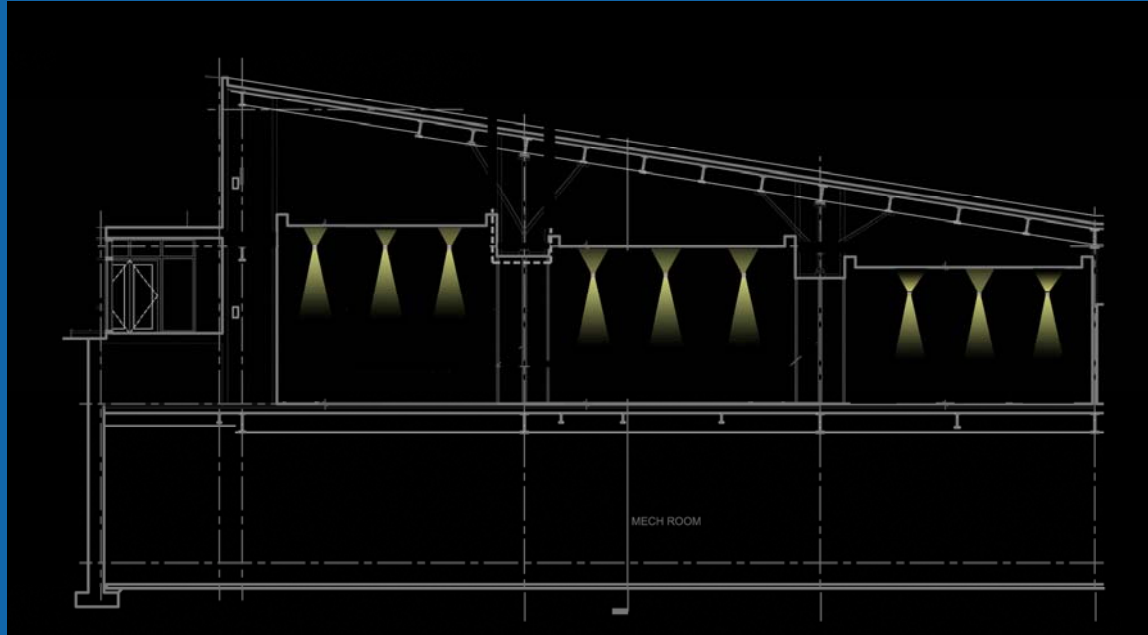

From Left-clockwise:

Section of Presentation Mode general lighting, floor plan with podium fixture and accent lighting, section with pendant lighting system and wall slot accent fixture

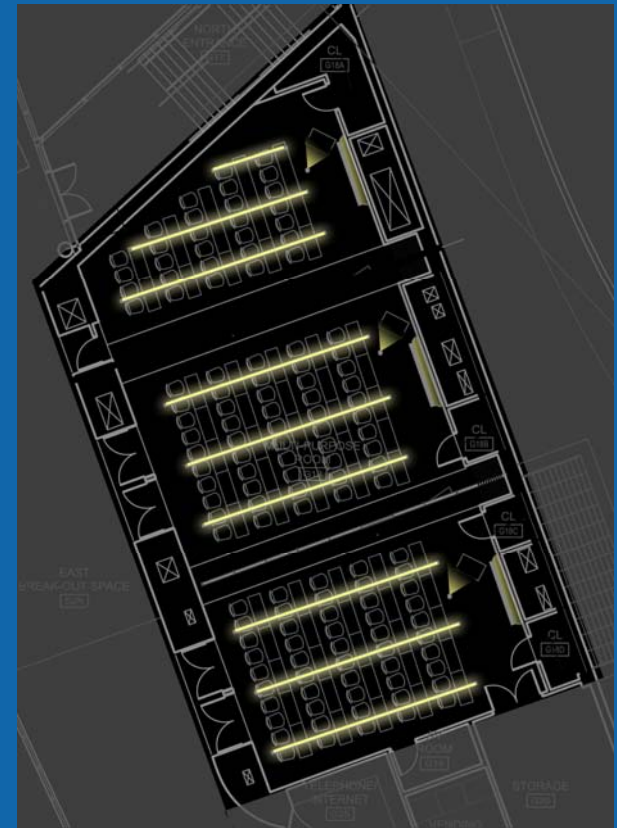
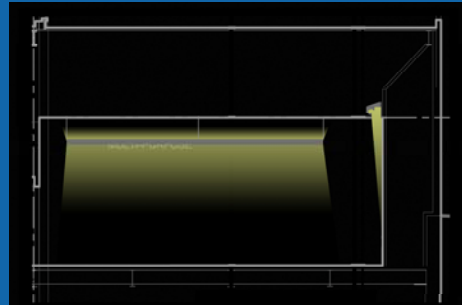

Multipurpose Room

Schematic Lighting Design: Presentation Mode

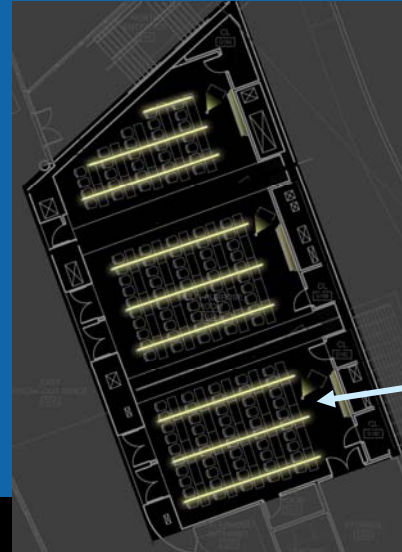
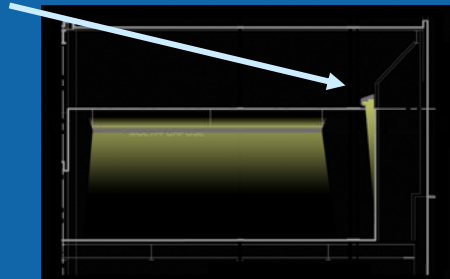
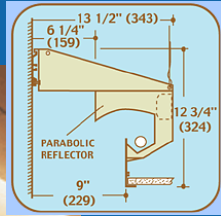

Recessed adjustable spotlight

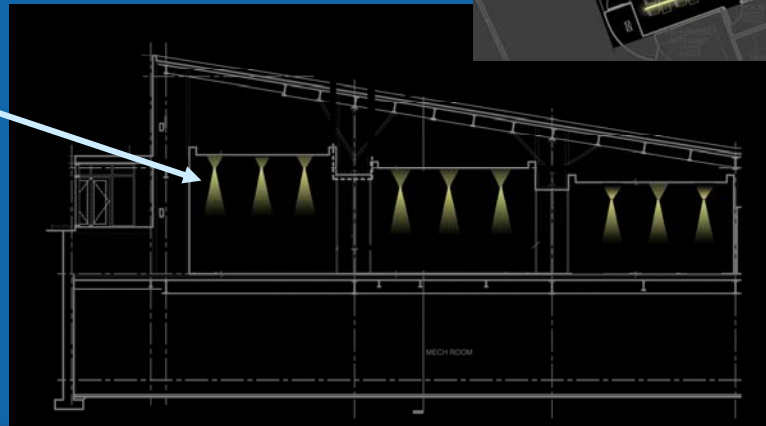

Multipurpose Room

Schematic Lighting Design: Banquet Mode

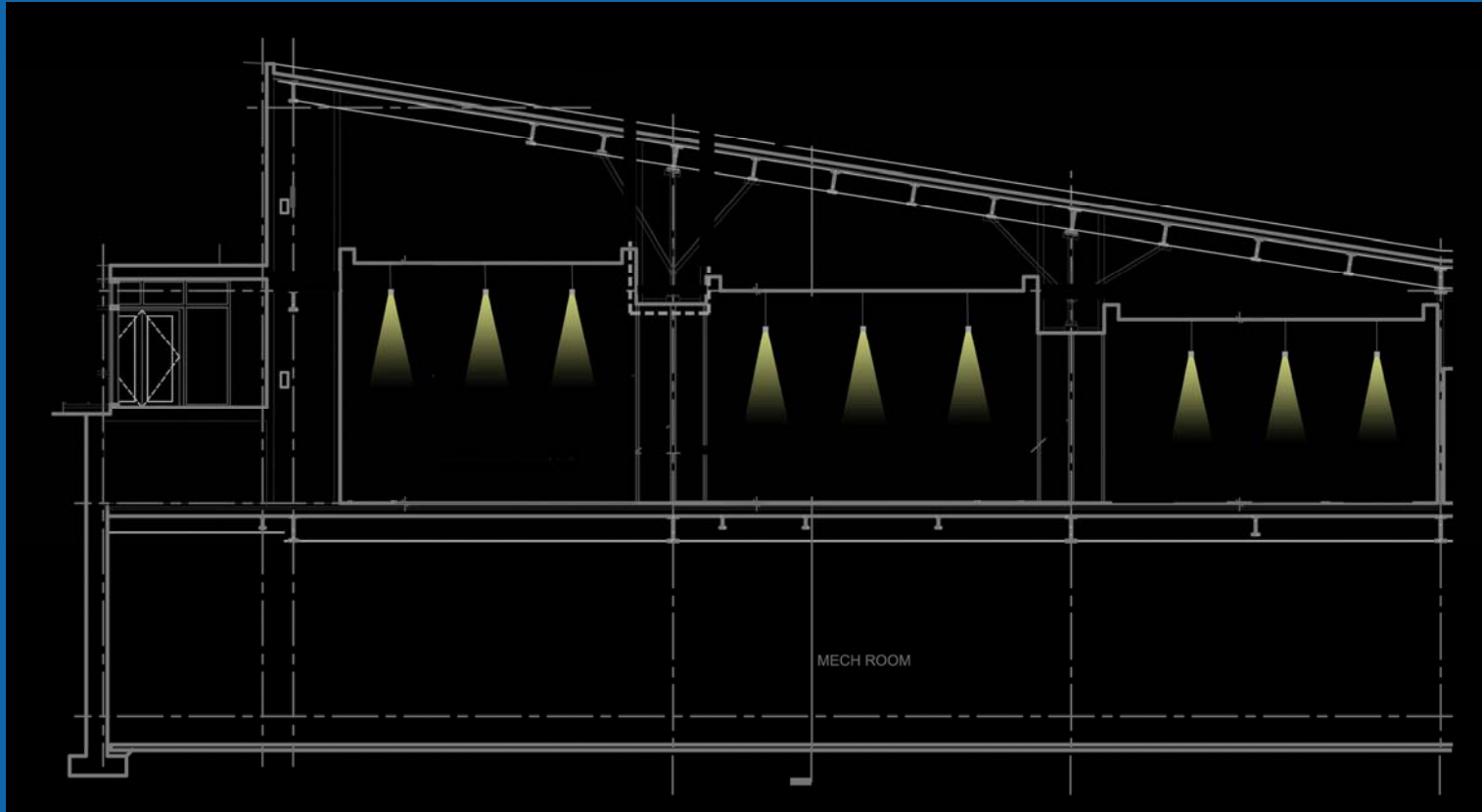

Multipurpose Room

Schematic Lighting Design: Banquet Mode

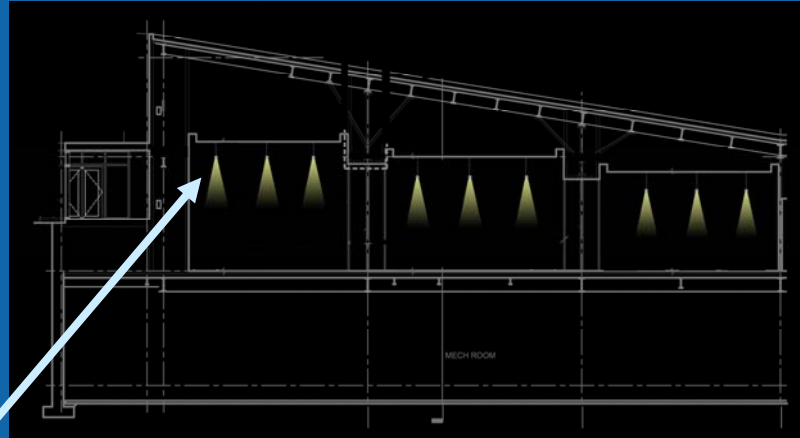

On Banquet Tables include a linear custom tabletop fixture for decorative lighting.

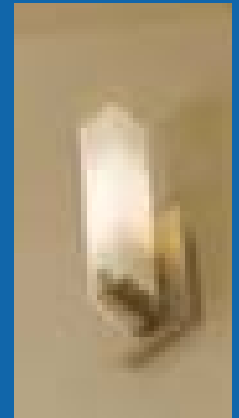

Open Office

Design Goals:

- Optimize the effects of natural light entering the space through the curved glass curtain wall.
- Minimize electric lighting required in the space.
- Avoid direct glare and veiling reflections due to VDT use.
- Distribute light uniformly across the horizontal task plane.
- Provide adequate illuminance levels on the work plane at all times of the day while avoiding direct sunlight.

Important Areas/Tasks:

- VDT use at desks
- Reading/Writing tasks at desks
- Reading files from filing cabinet



Open Office

Room Surface Materials

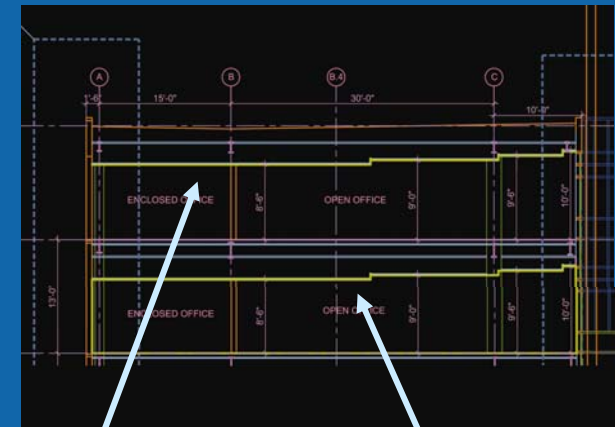
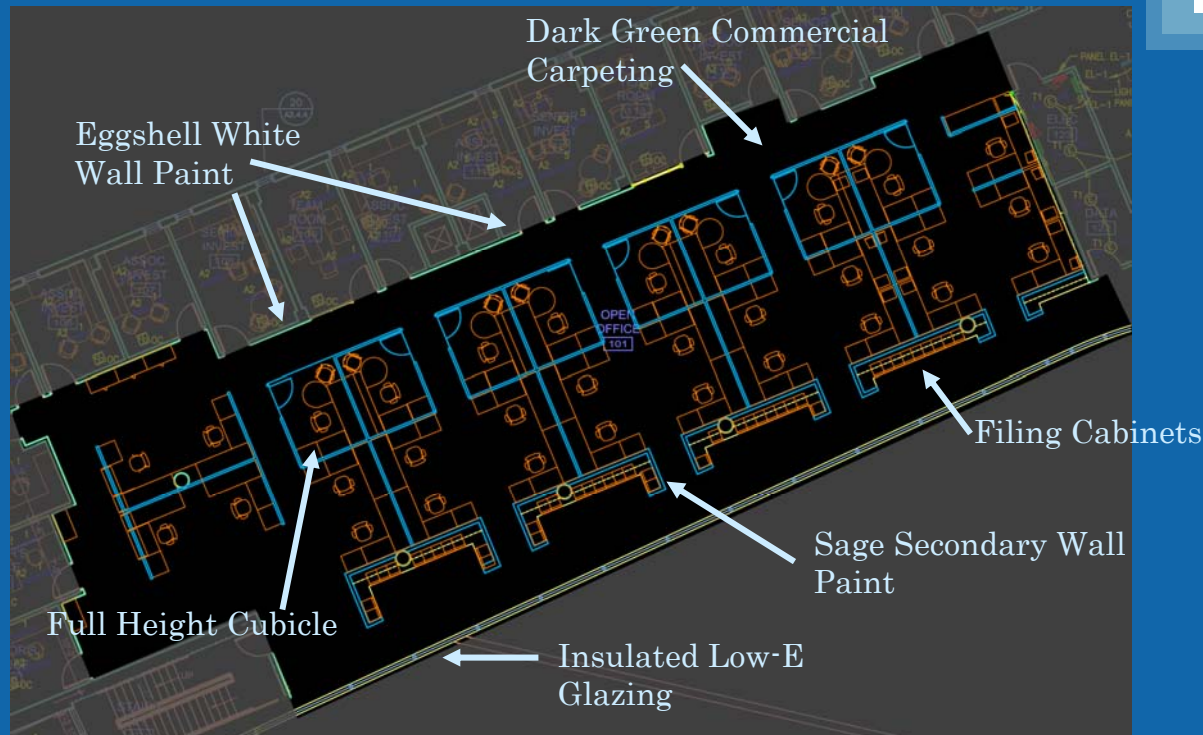

2'x4' Acoustical Ceiling Tile

Open Office

Open Office Existing Floor Plan

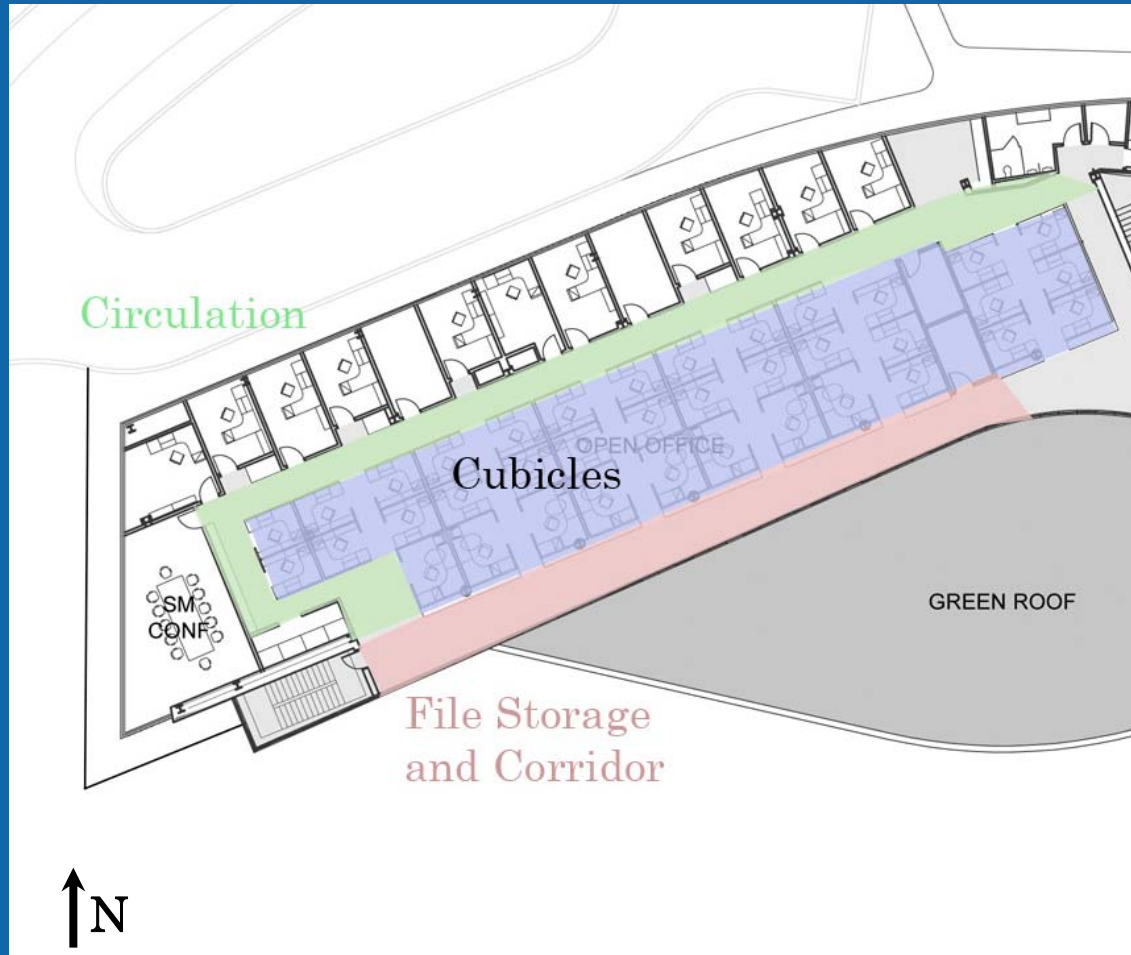

Proposed Floor Plan Adjustment:

- Move cubicle section of open office closer to windows to increase daylight
- Move File storage corridor to the back of the open office near the private offices because of the high partitions
- Move small circulation space to the front of the open office to act as a buffer for direct daylight.
- Incorporate automated shades with zonal photosensor dimming

Open Office

Schematic Lighting Design

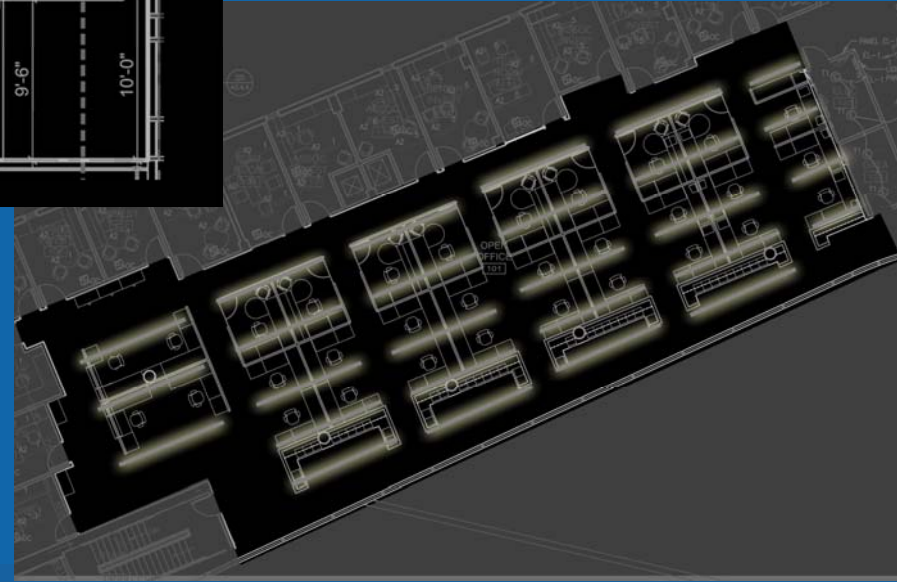
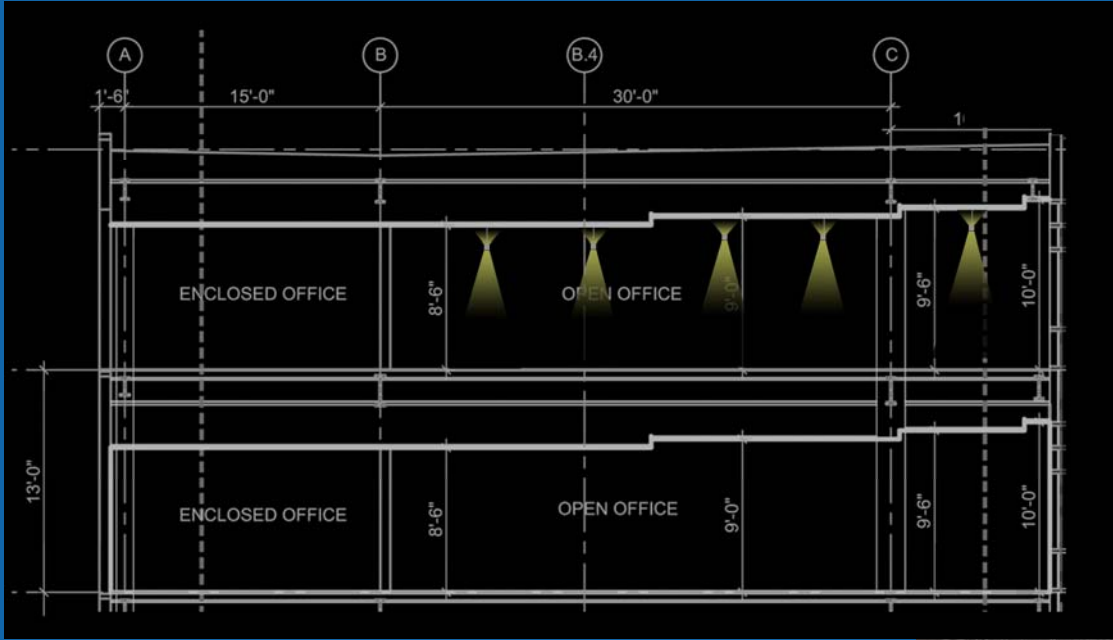

Open Office

Schematic Lighting Design

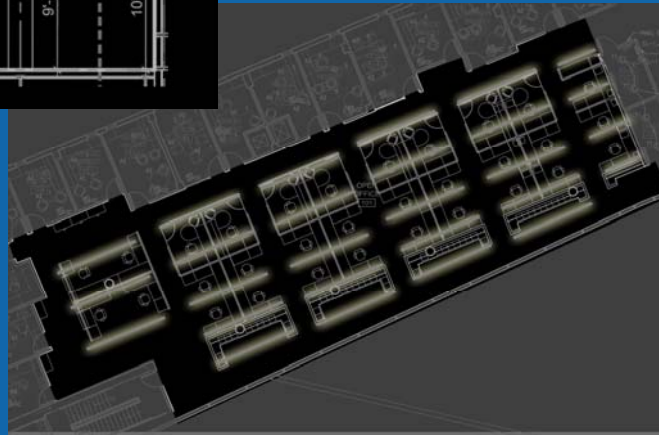
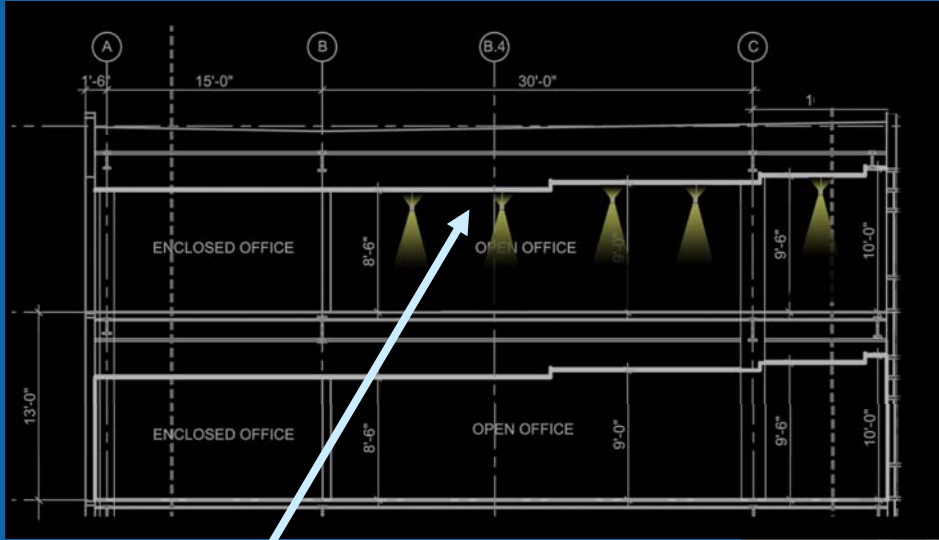

Exterior Lighting

Design Goals:

- Draw attention to the entrance of the building by layering light levels.
- Add interest to the exterior in forms other than façade lighting.
- Incorporate the interior lighting design of the main lobby with the exterior lighting design.
- Minimize light trespass from the site.

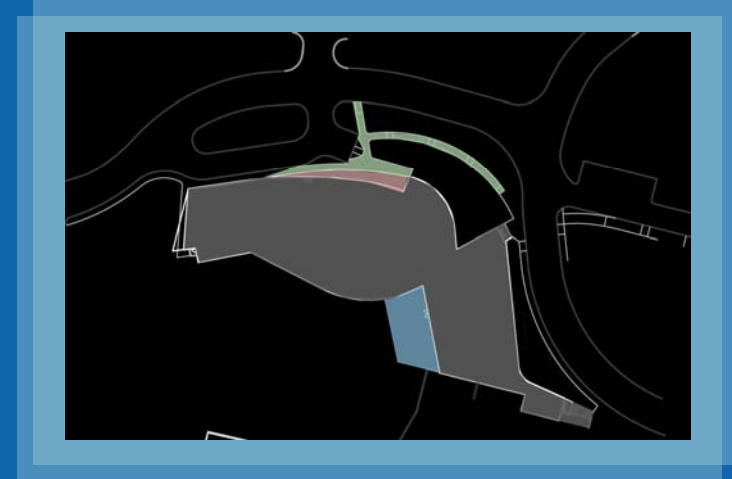

Important Areas:

- Entrance
- Pedestrian Pathway
- Terrace

Exterior Lighting

Main Entrance, Surrounding Landscape, and Terrace

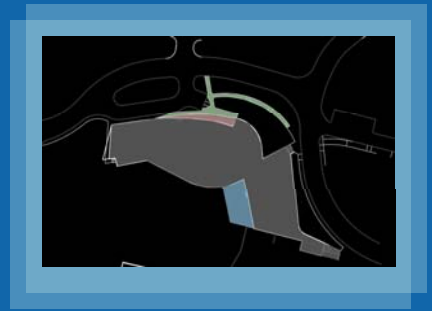

Exterior Lighting

Main Entrance, Surrounding Landscape, and Terrace

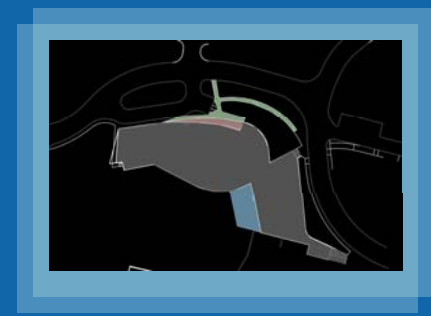

LED linear fixture
Mounted horizontally
To mimic the LED slot
In the lobby.

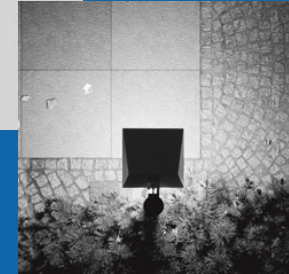
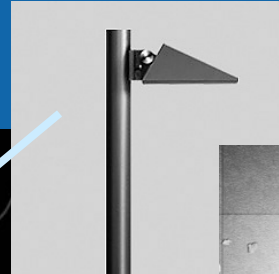

Exterior Lighting

Main Entrance

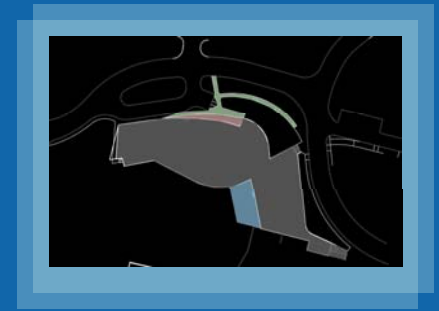
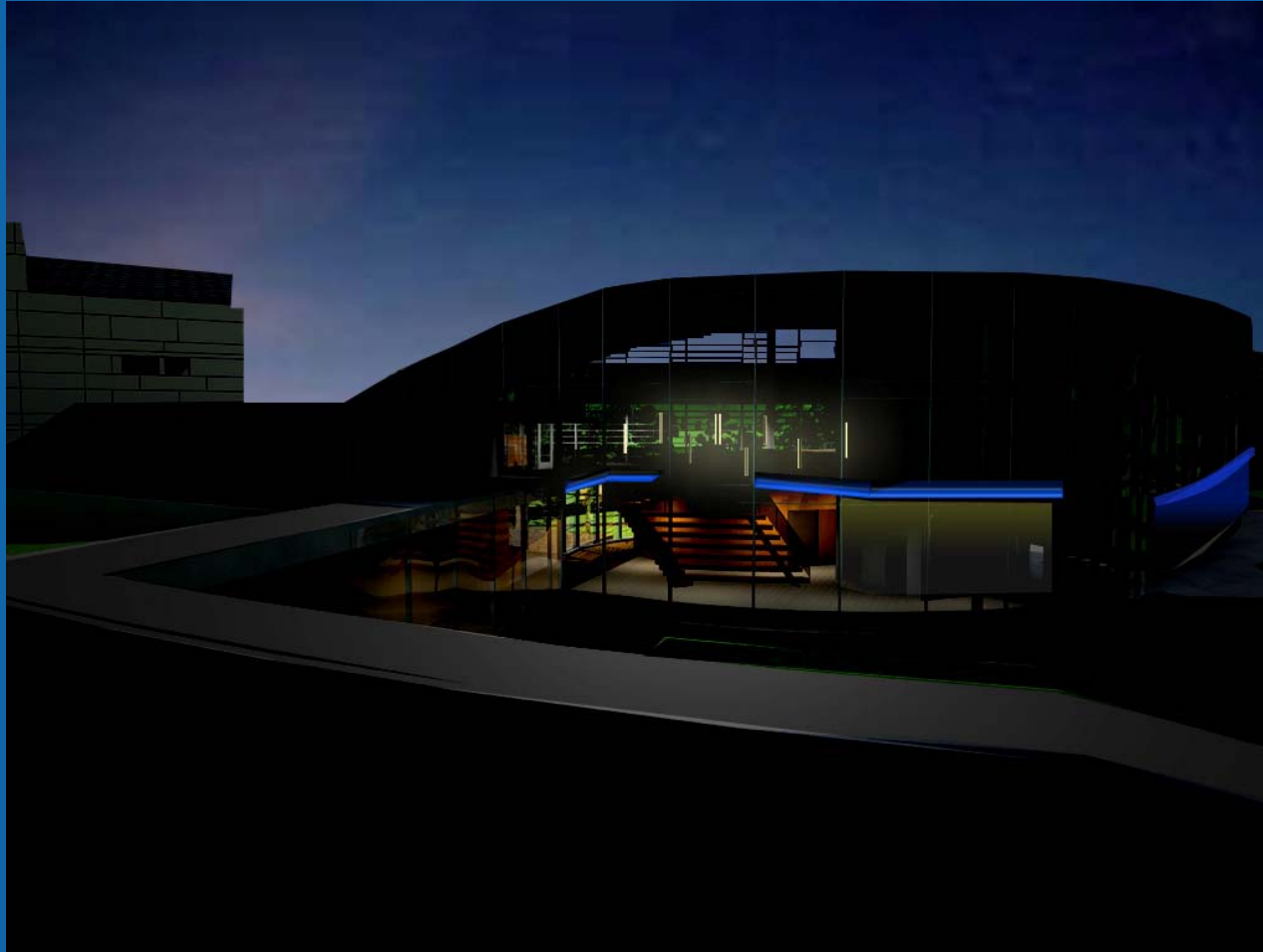

DEDICATED TO HEALTH CARE,
EDUCATION, RESEARCH, AND SERVICE

GEISINGER
Center for Health Research and Rural Advocacy



Thank You

Questions/Comments?